



## Product data sheet

EAN 4047526473204

ID 473207

### HPO 85X100/17-103K

#### Rolling resistance

■ ■ ■ ■ ■ Excellent

#### Operating noise

■ ■ □ □ □ Satisfactory

#### Floor surface preservation

■ ■ □ □ □ Satisfactory



#### Nylon roller for pallet trucks

##### Wheels:

Made of high-quality, impact-resistant nylon, very low rolling resistance, smooth running performance on even floors, very high abrasion resistance.









##### Tread/tyre:

Made of high-quality, impact-resistant nylon.

##### Wheel centre/rim:

-

## Technical data

<b>Wheel Ø</b>		85 mm (D)
<b>Wheel width</b>		100 mm (T2)
<b>Load capacity</b>		1100 kg
<b>Axle bore Ø</b>		17 mm (d)
<b>Clamping length</b>		103 mm (T5)
<b>unit weight</b>		0,7 kg
<b>Temperature resistance</b>		-25 ° C
<b>Temperature resistance to</b>		80 ° C
<b>tread and tyre hardness</b>		70° Shore D
<b>Bearing type</b>		Ball bearing

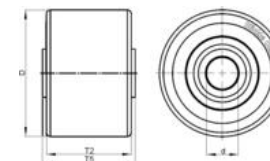

**Blickle Castors & Wheels Ltd.**

30, Vincent Avenue ▪ Crownhill, Milton Keynes ▪ Bucks MK8 0AB ▪ Telephone +44 1908 56 09 04 ▪ United Kingdom